



# IQ Battery 5P with FlexPhase

IQ Battery 5P with FlexPhase is an all-in-one AC-coupled system, that is powerful, reliable, simple, and safe. The battery can be flexibly used in both 1-phase and 3-phase applications. It has a total usable energy capacity of 5.0 kWh and includes six embedded IQ8T-BAT Microinverters providing up to 3.84 kVA continuous power in 1-phase configuration and 1.28 kVA continuous power per phase in 3-phase configuration.

## Components of the Enphase Energy System



### IQ System Controller 3 INT

The system controller is an integrated enclosure containing all components necessary for backup operation in case of grid outage.



### IQ Microinverters

IQ Series Microinverters pack more power into less space than other rooftop solar systems and make rooftop solar more productive, reliable, smart, and safe.



### IQ Combiner 2 EU 3P

The IQ Combiner 2 EU 3P is a pre-wired plug-and-play solution with IQ Gateway Metered, IQ Relays, Communications Kit 2, circuit breakers, and RCD.



### IQ Battery 5P with FlexPhase accessories

The lifting handles are reusable and ease the installation process. The pedestal enables floor mounting of the battery.

## Powerful

- Provides up to 3.84 kVA continuous power in 1-phase configuration and 1.28 kVA continuous power per phase in 3-phase configuration
- Includes six embedded IQ8T-BAT Microinverters

## Reliable

- 15-year limited warranty
- Cools passively with no moving parts or fans
- Uses wired communication for fast and consistent connection
- Updates software and firmware remotely

## Simple

- Fully integrated AC-coupled battery system
- Installs and commissions easily
- Supports Self-Consumption and Full Backup modes. Supports AI-based optimization to handle dynamic tariffs
- Offers homeowners remote monitoring and control from the Enphase App
- Field replaceable components

## Safe

- Meets UL 9540A, the highest industry standard for battery safety
- Uses lithium iron phosphate (LFP) chemistry for maximum safety and longevity



# IQ Battery 5P with FlexPhase

PRODUCT DETAILS			
Order code	—	IQBATTERY-5P-3P-INT	
Description	—	The IQ Battery 5P with FlexPhase is an AC-coupled battery (convertible between 1-phase and 3-phase) <sup>1</sup> with integrated IQ8T-BAT Microinverters and a battery management system (BMS) with battery controller	
OUTPUT	UNITS	1-PHASE	3-PHASE
Rated (continuous) output apparent power	kVA	3.84 or 3.68 <sup>2</sup>	3.84 (1.28 per phase)
Rated output current	A	16.70 or 16 <sup>3</sup>	16.7 (5.56 per phase)
Peak output current (3 seconds) <sup>4</sup>	A	32	32 (10.67 per phase)
Peak output current (10 seconds) <sup>4</sup>	A	24	24 (8 per phase)
Nominal voltage	VAC	230 V <sub>L-N</sub>	230 V <sub>L-N</sub> , 400 V <sub>L-L</sub>
Nominal voltage range	VAC	213–253	213–253 (per phase)
Nominal frequency	Hz	50	
Nominal frequency range	Hz	47.5–51.5	
Power factor, grid-tied (adjustable)	—	0.8 leading ... 0.8 lagging	
Power factor, backup	—	1.0 leading ... 1.0 lagging	
AC round-trip efficiency <sup>5</sup>	%	90	
Operating modes	—	Self-Consumption, Full Backup <sup>6</sup>	
BATTERY MODULE	UNITS		
Usable capacity	kWh	5.0	
DC round-trip efficiency <sup>7</sup>	%	96	
Nominal DC voltage	V	76.8	
Ambient operating temperature (charging) <sup>8</sup>	°C	-20 to 50	
Ambient operating temperature (discharging) <sup>9</sup>	°C	-20 to 55	
Chemistry	—	Lithium iron phosphate (LFP)	
MECHANICAL DATA	UNITS		
Dimensions (H × W × D)	mm	980 × 550 × 188	
Lifting weight	kg	69.5	
Total installed weight	kg	82.95	
IQ Battery enclosure	—	Outdoor-IP55	
IQ8T-BAT Microinverter enclosure	—	Outdoor-IP67	
Cooling	—	Natural convection	
Relative humidity (non-condensing)	%	5–95	
Altitude	m	<2500	
Mounting	—	Wall-mount (included) or pedestal-mount (sold separately)	
COMMUNICATION INTERFACES			
Communication	—	Wired control communication	
Monitoring	—	Enphase Installer Platform and Enphase App monitoring options; API integration	
STANDARDS			
Grid compliance	—	EN 62040.1, VDE AR-N 4105:2018, TOR Erzeuger Typ A V1.2 2022, ÖVE Richtlinie R25:2020-03	
EMI	—	CE, EFT, ESD, Surge, Voltage dips and interruptions, CRF	
Battery cell module	—	IEC 62619:2017, UN 38.3, UL1973	
Inverter	—	EN 62109-1, EN 62109-2, EN 62909-1:2017, EN 50549-1:2019	
EC Declaration of Conformity <sup>10</sup>	—	Directive 2014/30/EU on electromagnetic compatibility (EMC), Directive 2014/35/EU (Low Voltage Directive, LVD), Directive 2011/65/EU on restrictions of the use of certain dangerous substances in electrical and electronic equipment (RoHS), Directive EU2014/53/EU on the making available on the market of radio equipment (Radio Equipment Directive, RED), Battery Directive 2006/66/EC	

<sup>1</sup> Factory default configuration is set to 1-phase. To switch to a 3-phase configuration, refer to the instructions provided in the QIG.

<sup>2</sup> The continuous apparent power output for 1-phase configuration is 3.68 kVA for Austria and Switzerland.

<sup>3</sup> The rated output current for 1-phase configuration is 16 A for Austria and Switzerland.

<sup>4</sup> During backup operation.

<sup>5</sup> AC to battery to AC at 1.92 kVA power rating, at 25°C and at the beginning of life.

<sup>6</sup> For the Backup mode, the IQ System Controller 3 INT is required.

<sup>7</sup> At the beginning of life.

<sup>8</sup> Reduction in charging power will occur at temperatures below 15°C and above 45°C.

<sup>9</sup> Reduction in discharge power will occur at temperatures below 5°C and above 50°C.

<sup>10</sup> Full text of the EU Declaration of Conformity (DoC) is available at <https://www.enphase.com>.

**LIMITED WARRANTY**

Limited warranty

>60% capacity, up to 15 years or 6000 cycles<sup>11</sup>**WHAT'S IN THE BOX (ORDER CODE: IQBATTERY-5P-3P-INT)**

IQ Battery 5P with FlexPhase	Base battery unit of IQ Battery 5P with six integrated IQ8T-BAT Microinverters
ID cover and conduit cover	IQ Battery ID cover along with four conduit covers, two each for the left and right sides of the unit
Bottom mounting bracket and top protective shield	Bottom mounting bracket for mounting the battery unit on the wall and one top protective shield
M5 locking screws	Two M5 locking screws for securing the battery unit on the bottom mounting bracket
M4 grounding screws	Two M4 grounding screws for securing the top protective shield on the bottom mounting bracket
M5 ID cover grounding screws	Two M5 ID cover grounding screws for the EMI/EMC requirement
Cable ties	Six cable ties for securing field cables to the unit
Control (CTRL) connector	One pre-installed and one spare CTRL connector without resistor for CTRL wiring
Control (CTRL) connector with resistor	One pre-installed and one spare CTRL connector with resistor for CTRL wiring
Quick install guide (QIG)	IQ Battery 5P with FlexPhase Installation instructions
Control (CTRL) drain connector	One pre-installed and one spare CTRL drain connector for CTRL wiring
Drill template	One drill template for marking drilling locations on the mounting surface

**ACCESSORIES AND REPLACEMENT PARTS**

IQBATTERY-5P-3P-INT-RMA	Enphase IQ Battery 5P battery storage: Indoor/Outdoor (INT) for replacement
B305-CX-0550-O	IQ Battery 5P cover only (includes one ID cover)
B305-CP-096-O	IQ Battery 5P conduit plates only (includes four conduit covers, two each for left and right sides of the unit)
B05-WB-0543-O	IQ Battery 5P wall bracket only (includes one wall bracket and one top shield)
B05-PM-0550-O	IQ Battery 5P pedestal mount
IQBATTERY-HNDL-5	One set of IQ Battery 5P lifting handles (Includes one left-side and one right-side lifting handle)
B305-ACFB-080-O	IQ Battery 5P AC Filter board only (includes AC filter board PCBAs)
B305-BMSIA-0490-O	IQ Battery 5P BMS board only (includes one BMS board PCBA of INT)
B305-IICS-0524-O	IQ Battery 5P in-house control switch only. Includes one inhouse control switch preinstalled on the IQ Battery 5P wiring cover (INT)
B305-CANBI-042-O	IQ Battery 5P control communications board only (includes one control communications PCBA)
IQ8T-BAT-RMA	Enphase IQ8T-BAT Microinverter for IQ Battery 5P with Flexphase
B305-TBL-077-O	IQ Battery 5P Line terminal block
B305-TBN-077-O	IQ Battery 5P Neutral terminal block
B305-TBG-077-O	IQ Battery 5P Ground terminal block
B305-FUSE-085-O	IQ Battery 5P fuse
B305-TBJ-085-O	IQ Battery 5P Jumper

**COMPATIBILITY**

IQ Combiner 2 EU 3P	X-I Q-EURO-230-3P-4-2
IQ Battery 5P	IQBATTERY-5P-1P-INT
IQ Gateway Metered	ENV-S-EM-230
IQ Relay (single-phase and three-phase)	Q-RELAY-1P-INT and Q-RELAY-3P-INT
Communications Kit 2 INT (for grid-tied operation)	COMMS-KIT-INT-02
IQ System Controller 3 INT (for backup operation)	SC100G-M230ROW
Solar inverters	IQ7, IQ8 Series Microinverters, third-party PV string inverters

<sup>11</sup> Whichever occurs first. Restrictions apply. The full text of the warranty is available at <http://enphase.com/installers/resources/warranty>.

Dimensions in mm

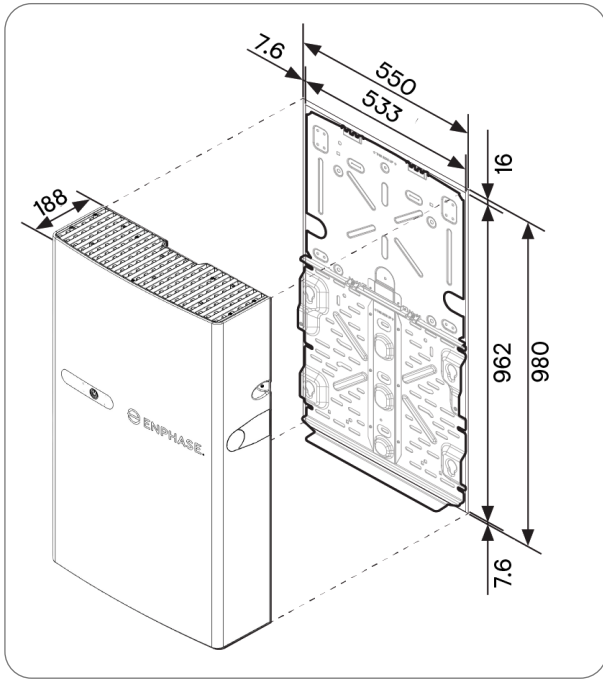

Wall-mounted

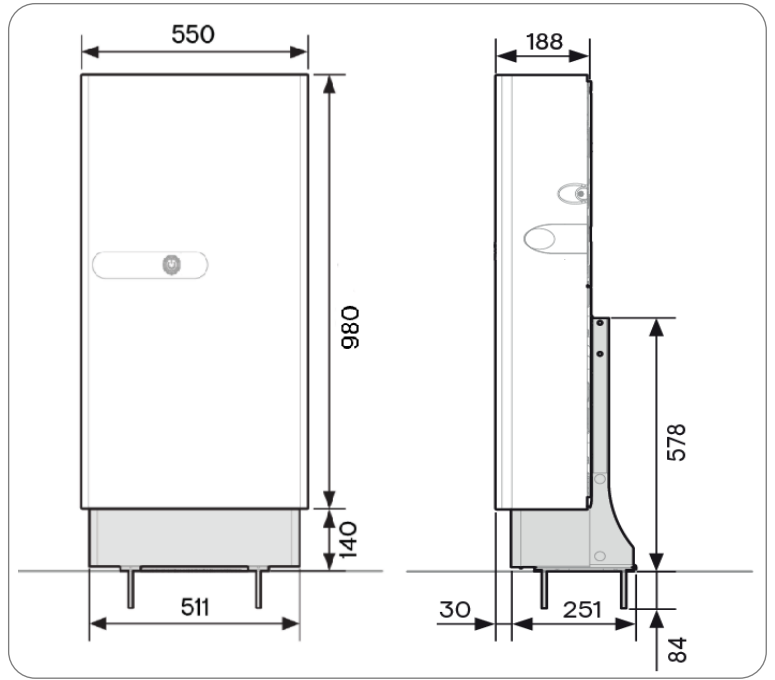

Floor-mounted with pedestal

Note for third-party products:

Any third-party manufacturer or importer of product(s) used to install or commission Enphase product(s) shall comply with the applicable EU Directive(s) and requirements in the European Economic Area (EEA). It is the responsibility of the installer to confirm that all such products are labelled correctly and have the required compliant supporting documentation.

**Manufacturer:** Enphase Energy Inc., 47281 Bayside Pkwy., Fremont, CA, 94538, United States of America, PH: +1 (707) 763-4784

**Importer:** Enphase Energy NL B.V., Het Zuiderkruis 65, 5215MV, 's-Hertogenbosch, The Netherlands, PH: +31 73 3035859  
Assembled in China.

# Revision history

REVISION	DATE	DESCRIPTION
DSH-00477-1.0	June 2024	Preliminary release.

# IQ System Controller 3 INT

The IQ System Controller 3 INT connects homes to the public grid, IQ Battery 5P, and IQ7 or IQ8 Microinverters. It features an automatic transfer switch (ATS) that switches from grid to backup power during outages. The system consolidates interconnection equipment, IQ Gateway Metered, and IQ Relay functionalities into one enclosure, enhancing grid-independent capabilities with a pre-wired solution, including CTs.



Key specifications	SC100G-M230ROW
Nominal voltage	230 VAC (Line-to-Neutral) 400 V (Line-to-Line)
Maximum continuous grid current per phase	80 A
Maximum PV/IQ Battery current per phase	80 A
Maximum backup load current per phase	80 A
Supported Earthing systems	TN-C-S, TN-S, TT
Backup operation	Single-phase/Three-phase
Dimensions (H x W x D)	760 mm x 500 mm x 158 mm
Weight	15.2 kg
Enclosure environmental rating	Outdoor, IP55, polycarbonate construction

Install IQ System Controller 3 INT with clearance at the left, right, top, bottom, and front.

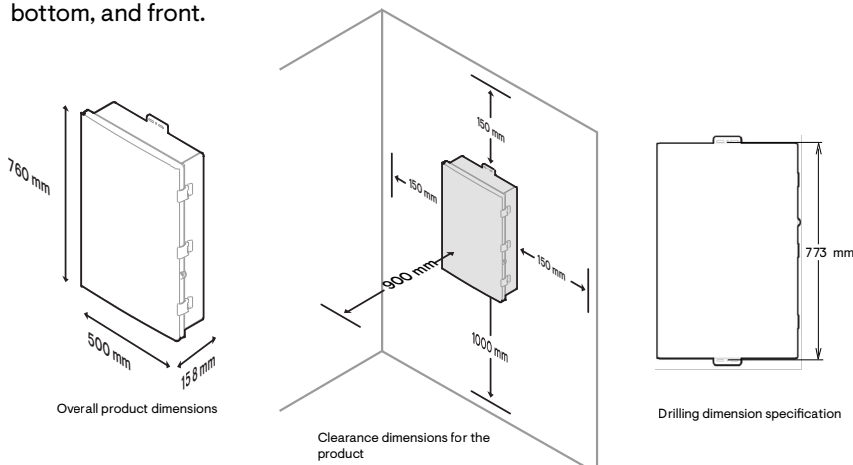

## Simple

- Supports three-phase and single-phase configurations for solar and grid
- Supports conduit entry from the bottom, rear, left, and right
- Supports IQ8, IQ7, and S Series Microinverters
- Supports main circuit breaker up to 80 A
- Pre-wired CTs on PV and grid terminals for ease of wiring
- Field replaceable components
- Integrated IQ Gateway board, Production CT, Consumption CT, and IQ Relay functionality

## Reliable

- Durable IP55 enclosure
- 10-year limited warranty

## Smart

- Controls safe connectivity to the grid
- Detects power cuts automatically
- Provides near seamless transition to backup
- Uses wired communication for fast and consistent connection
- Installs and commissions easily
- Offers homeowners remote monitoring and control from the Enphase App

Product details		Order code: SC100G-M23OROW
Description	IQ System Controller 3 INT includes an automatic transfer switch (ATS), Integrated IQ Gateway, Production and Consumption CTs, IQ Relay functionalities, and a Mobile Connect device. It streamlines the grid-independent capabilities of PV and storage installations. It also includes a System Shutdown Switch (SC-INT-SSD-KIT) to safely turn off the system and an Enphase Mobile Connect CELLMODEM-M1-06-AT-05 or CELLMODEM-07-INT-05 (with a 5-year data plan) to ensure backup internet connectivity <sup>1</sup>	
Electrical specifications	Units	
Nominal voltage	VAC	230 (Line-to-Neutral), 400 (Line-to-Line)
Nominal voltage range	VAC	184–276 (Line-to-Neutral), 320–480 (Line-to-Line)
Feed-in type	–	Single-phase/Three-phase
Voltage measurement accuracy	VAC	±1.8
Overvoltage category	–	Category III
Nominal frequency/range	Hz	50/47–52
Maximum continuous grid current per phase	A	80
Maximum PV/IQ Battery current per phase	A	80
Maximum backup load current per phase	A	80
Environment	–	B
Backup operation	–	Single-phase/Three-phase
Maximum overcurrent protection device rating for IQ Gateway	A	16; installed and pre-wired along with IQ System Controller 3
Load transition time <sup>2</sup>	ms	0
Maximum power quality variation time <sup>2</sup>	ms	30
Maximum grid isolation time <sup>3</sup>	ms	120
Operating modes	–	Self-Consumption: Use stored solar to power your home after the sun goes down. The battery is used when the solar is not available Full Backup: 100% of the battery is reserved for backup
Supported Earthing systems		TN-C-S, TN-S, TT
Auxiliary contact for load control and excess PV control		2 × Type NO and 2 × Type NC, 230 VAC RMS/24 VDC, 1 A
Mechanical data	Units	
Dimensions (H × W × D)	mm	500 mm × 760 mm × 158 mm
Weight	kg	15.2
Circuit breaker space (DIN rail)	–	DER side: Space for 10 single-pole breakers Mains and backup side: Space for eight single-pole breakers
Mounting options	–	Wall mount
Ambient temperature range	°C	–40 to 50
Operating humidity (RH)	%	Up to 100, condensing

<sup>1</sup> Enphase requires Wi-Fi or Ethernet as a primary mode of interconnectivity for any system with IQ Battery 5P.

<sup>2</sup> This refers to load disruption during grid blackout. When transitioning to backup, the total power of the IQ Battery installed needs to be greater than the loads present. Load disruption time may vary based on other grid conditions. Contact Enphase Support for more details.

<sup>3</sup> Refers to the time from which grid outage happens to the time when grid (ATS/MID) relays open up.

Mechanical data		Units	
Cooling	—		Natural convection, solar shield
Enclosure environmental rating	—		Outdoor, IP55, polycarbonate construction
Altitude	m		Up to 2000
Warranty			
Limited warranty (restrictions apply)			Up to 10 years (SC-INT-SSD-KIT and CELLMODEM-M1-06-AT-05 or CELLMODEM-07-INT-05 have a 5-year warranty)
What's in the box			
IQ System Controller 3 INT			System controller unit with microgrid interconnect device
System Shutdown Switch			Switch to shut down the Enphase Energy System
Circuit breakers			1-pole IQ Gateway reset breaker
Accessories kit			IQ System Controller 3 INT quick install guide (QIG), breaker filler plate
Mobile Connect cellular modem			Cellular modem along with a 5-year data plan to ensure backup internet connectivity
Accessories and replacement parts			
SC-IQG-PCBA-ROW			IQ Gateway board for field replacement
SC-ECB-PCBA-ROW			Embedded controller for field replacement
SC-PRB-SUB-ROW			Power relay board for field replacement
SC-IOB-PCBA-ROW			Interface board or I/O board with dry contacts for field replacement
SC-MRA-SUB-ROW			Mains relay assembly for field replacement
Circuit breakers (as needed)			DIN rail mounted. Not included, must order separately.
SC-INT-SSD-KIT			System Shutdown Switch for solar and battery systems. Turns off the system and prevents microgrid formation
CELLMODEM-M1-06-AT-05 or CELLMODEM-07-INT-05			Cellular modem to provide backup internet connectivity to the Enphase Energy System
Compatibility			
Battery			IQ Battery 5P (IQBATTERY-5P-1P-ROW/IQBATTERY-5P-3P-INT)
Microinverters			IQ8 Series, IQ7 Series, or S Series
Compliance			
Safety			AS/NZS IEC 61439-2, IEC 60947-6-1
EMC and radio equipment			RCM, IEC 61000-6-1, IEC 61000-6-3, EN 55024, EN 300 328, EN 300 440, EN 301 489-1, EN 301 489-17, EN 301 489-52, EN 301 511, EN 301 893, EN 301 908-1
Performance			AS/NZS 4777.2:2020 + A2
Wire sizes			
Connections (all lugs are rated to 90°C)	Main lugs and backup load lugs		Cu: 2.5 mm <sup>2</sup> to 35 mm <sup>2</sup>
Neutral and ground bars	Large holes		2.5 mm <sup>2</sup> to 35 mm <sup>2</sup>
	Small holes		2.5 mm <sup>2</sup> to 15 mm <sup>2</sup>

Assembled in China

Manufacturer: Enphase Energy Inc., 47281 Bayside Pkwy., Fremont, CA, 94538, United States of America, PH: +1 (707) 763-4784

Importer: Enphase Energy Aust. Pty/Ltd., 88 Market St., South Melbourne VIC 3205, PH: +61 3 86691679

# Components of the Enphase Energy System



## Microinverters

Microinverters pack more power into less space than other rooftop solar systems and make rooftop solar more productive, reliable, smart, and safe.



## IQ Battery 5P with FlexPhase

IQ Battery 5P's all-in-one AC-coupled storage system is powerful, reliable, simple, and safe. It has a total usable energy capacity of 5.0 kWh and includes embedded IQ8T-BAT Microinverters for reliable operation.



## IQ Battery 5P

Powerful and fully integrated AC Battery with 5 kWh capacity. Includes six embedded IQ8D-BAT Microinverters for high reliability.



## Mobile Connect cellular modem

Mobile Connect cellular modem provides plug-and-play connectivity to the Enphase Installer Platform. It is preconfigured for data service and becomes activated when connected to the IQ System Controller 3 INT.



# Revision history

Revision	Date	Description
DSH-00008-4.0	June 2025	<ul style="list-style-type: none"><li>• Editorial updates.</li><li>• Updated “Product details”, “Electrical specifications”, “What’s in the box”, “Warranty”, “Accessories and replacement parts”, and “Compliance” sections.</li><li>• Added “Components of the Enphase Energy System” section.</li></ul>
DSH-00008-3.0	February 2024	Updated “Electrical specifications” and “Compliance” sections.
DSH-00008-2.0	July 2023	<ul style="list-style-type: none"><li>• Added new sections “What’s in the box” and “Compatibility”.</li><li>• Updated the sections “Electrical specifications” and “Accessories and replacement parts”.</li></ul>
DSH-00008-1.0	May 2023	Initial release.